





Hotel Lobby (1st floor)



ROOM	DIMENSIONS			CAPACITY OF EACH LAYOUT (PERSONS)				
	AREA (M ²)	LENGTH WIDTH (M)	CEILING HEIGHT (M)	 COCKTAIL	 THEATRE	 BANQUET	 CLASSROOM	 MEETING
DIAMOND A+B	400	28.6 X 14	6.3	350	450	360	300	110
DIAMOND A	280	20 X 14	6.3	160	200	120	110	40
DIAMOND B	120	8.6 X 14	6.3	80	120	70	60	20

Hotel Lobby (1st floor)

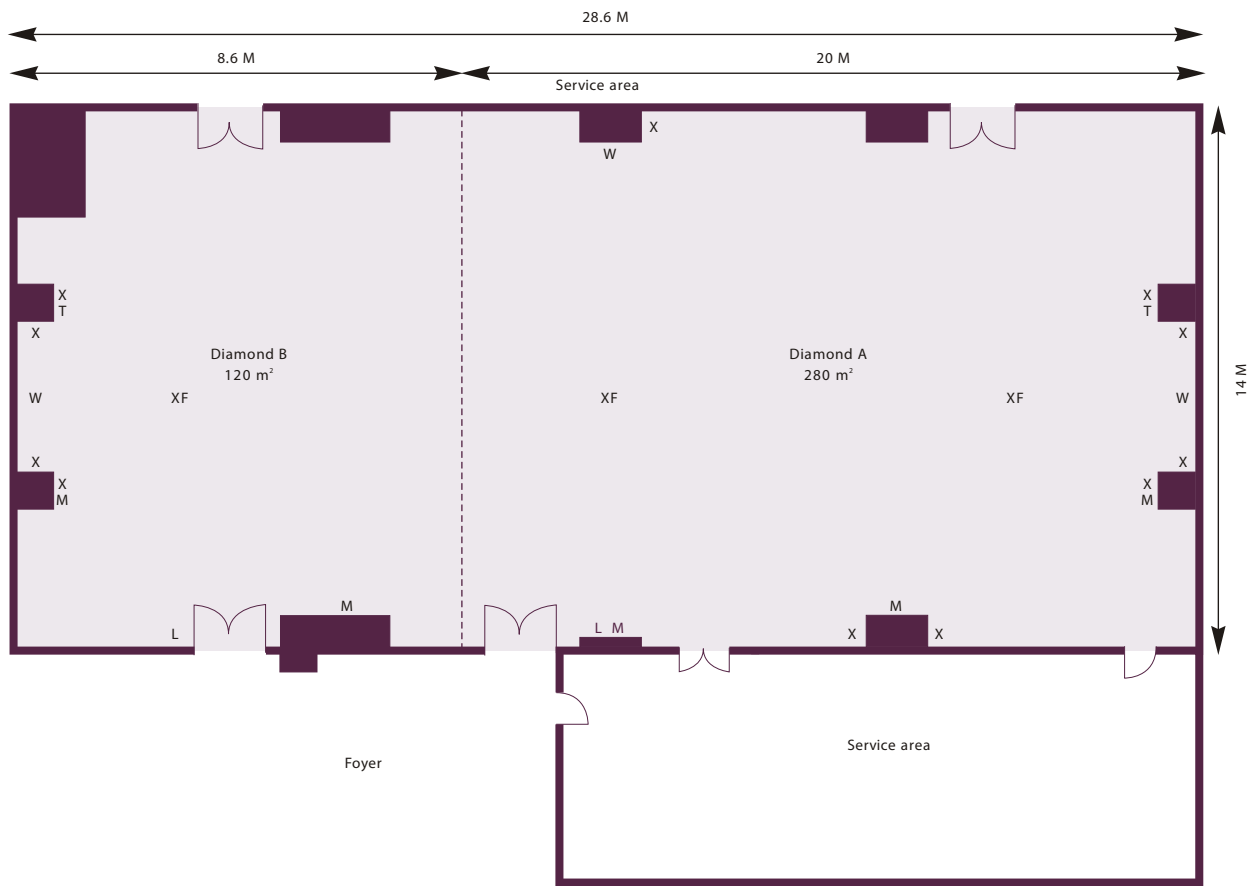

- | | |
|----|-----------------------|
| XF | Socket (On the floor) |
| X | Socket (On The wall) |
| M | Microphone |
| L | Lighting control |
| T | Telephone Line |
| S | Sound Control |
| W | Wall mounted Screen |

AUDIO-VISUAL EQUIPMENT

- Central sound amplifier
- Wall mounted screens
- PAL/NTSC video recorder
- Wireless microphones
- Telephone, fax connections
- Light dimmers

ADDITIONAL AVAILABLE EQUIPMENTS

- Computer and video projectors
- Overhead projector, slide projector, CD player, DVD player, tape recorder, video recorder (VHS, PAL-SECAM)
- Video conference equipment, exhibition stand, stage, lectern
- Simultaneous translation system with infra-red headphones (up to 6 languages)
- Built-in interpretation booths
- Flip chart
- Video camera
- Plants and flowers



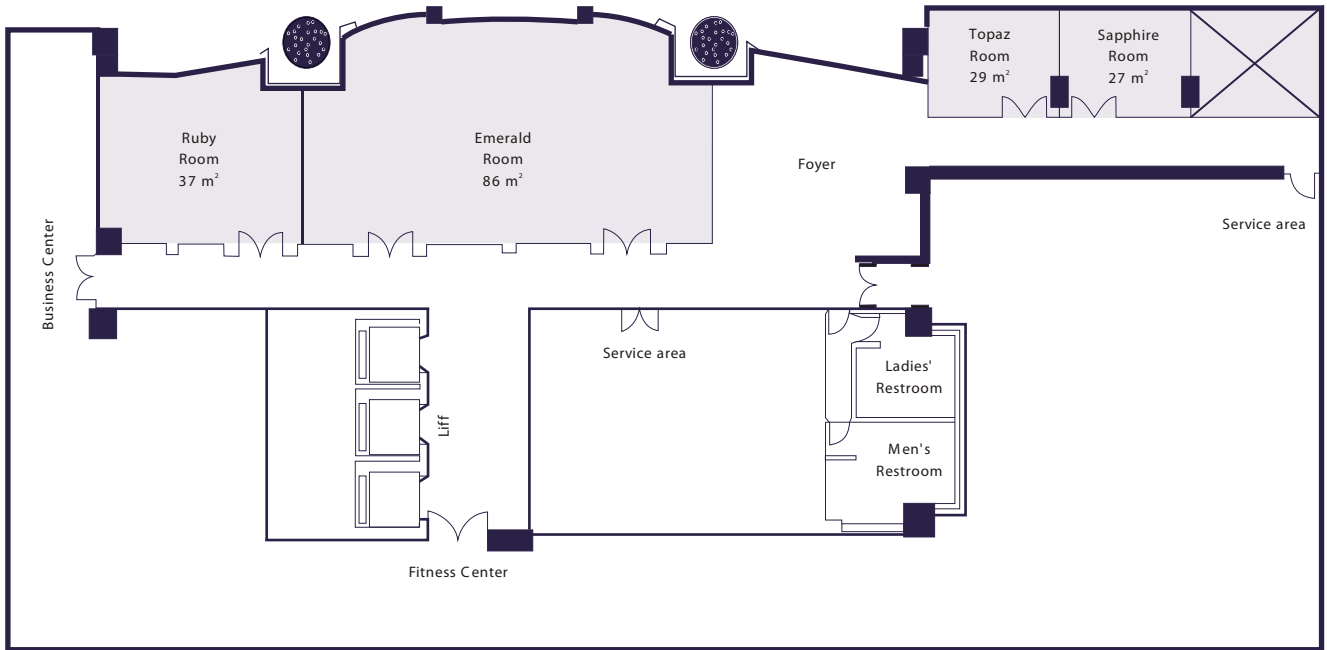

3rd floor meeting room area

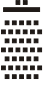

ROOM

DIMENSIONS

CAPACITY OF EACH LAYOUT (PERSONS)

ROOM	DIMENSIONS			CAPACITY OF EACH LAYOUT (PERSONS)				
	AREA (M ²)	LENGTH WIDTH (M)	CEILING HEIGHT (M)	 COCKTAIL	 THEATRE	 BANQUET	 CLASSROOM	 MEETING
EMERALD*	86	14.3 X 6	3	60	60	50	40	30
RUBY*	37	7 X 5.3	3	NA	30	20	20	15
TOPAZ	29	6.5 X 4.4	3	NA	NA	NA	NA	15
SAPPHIRE	27	6.2 X 4.4	3	NA	20	12	15	10

*Natural light

3rd floor meeting room area

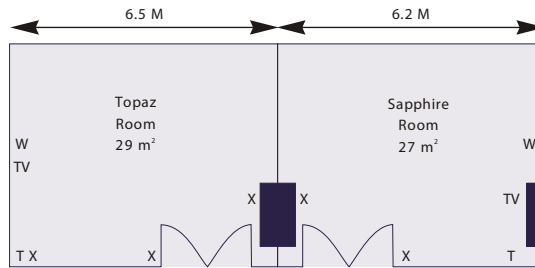
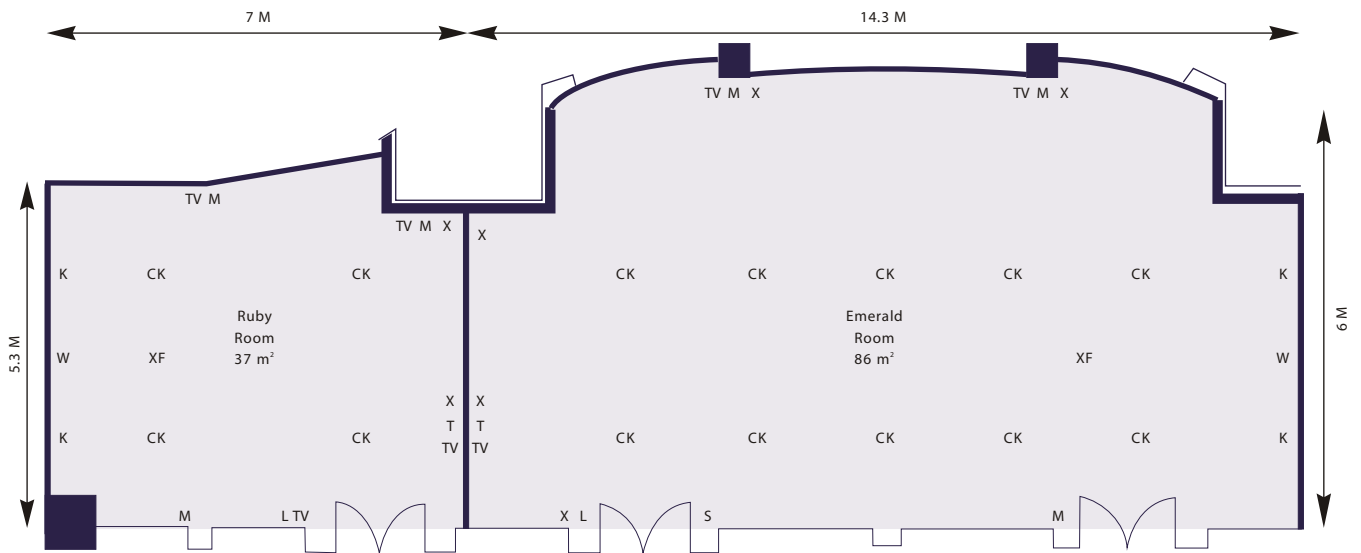

- | | |
|----|-----------------------|
| XF | Socket (On the floor) |
| X | Socket (On The wall) |
| M | Microphone |
| L | Lighting control |
| T | Telephone Line |
| K | Speaker |
| CK | Ceiling speaker |
| TV | Television |
| W | Wall mounted Screen |

AUDIO-VISUAL EQUIPMENT

- Central sound amplifier
- Wall mounted screens
- PAL/NTSC video recorder
- Wireless microphones
- Telephone, fax connections
- Light dimmers

ADDITIONAL AVAILABLE EQUIPMENTS



- Computer and video projectors
- Overhead projector, slide projector, CD player, DVD player, tape recorder, video recorder (VHS, PAL-SECAM)
- Video conference equipment, exhibition stand, stage, lectern
- Simultaneous translation system with infra-red headphones (up to 6 languages)
- Built-in interpretation booths
- Flip chart
- Video camera
- Plants and flowers

18th floor outdoor pool terrace

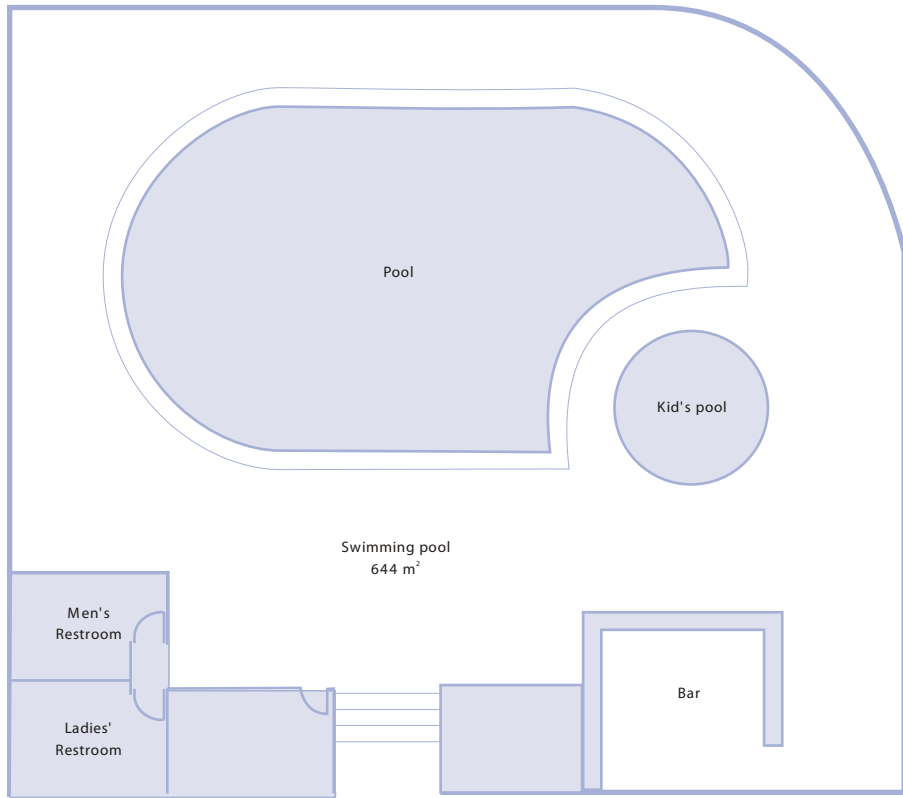

Saigon River View



AREA	DIMENSIONS		CAPACITY OF EACH LAYOUT (PERSONS)	
	AREA (M ²)	LENGTH WIDTH (M)	 COCKTAIL	 BANQUET
SWIMMING POOL	644	28 X 23	150	70